

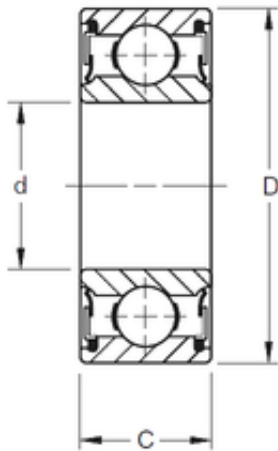

SGL BEARING- EUROPE LTD.

20 mm x 52 mm x 15 mm TIMKEN 304PP Single Row Ball Bearings



Bearing No. 304PP

Size	20x52x15 mm
Bore Diameter	20 mm
Outer Diameter	52 mm
Width	15 mm
d	20 mm
D	52 mm
B	15 mm
C	15 mm
Weight	0,141 Kg
Basic dynamic load rating (C)	17,9 kN

304PP Bearing 2D drawings and 3D CAD models